



Warning!

Flat glass units are heavy.
Some units may require a mechanical lift

Contents

i Please unpack and check that all correct parts are included and undamaged.

All Standard Flat Glass Rooflights

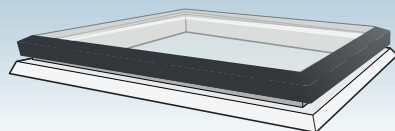

For Standard Flat Glass
Rooflight on to 150mm or
300mm Kerb
See Page 2 overleaf

Fixing Quantities

Length of Nominal Dome Side (mm)	Number of fixings per side
600, 750	2
900, 1050, 1200	3
1350, 1500, 1650	4
1800, 1950	5
2100, 2250	6
2400	7

(All fixings supplied in packs of 5.)

With either assembly, you will receive:

Kerb Fixings

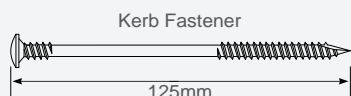

With either assembly, you will receive:

Opening Unit Extras

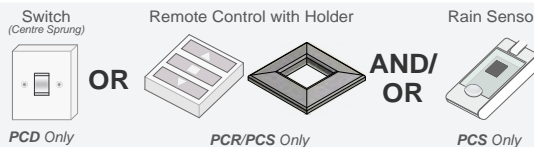

Installation

⚠ Please note that all Health and Safety Regulations must be followed on site throughout the installation process.

Powered PCD/R/S Opening rooflight on existing upstand

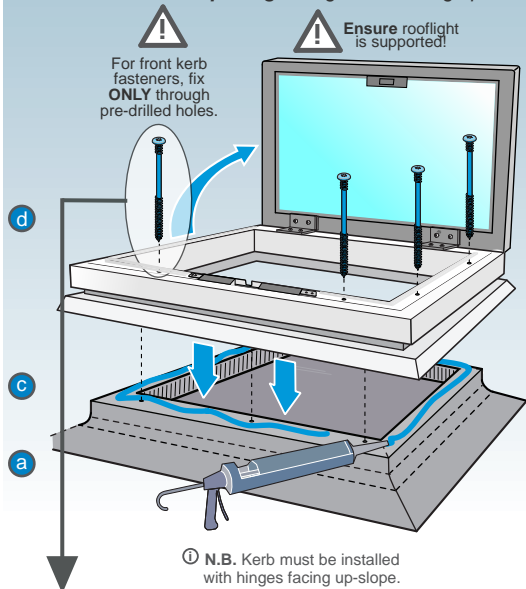

Rooflight connection to frame

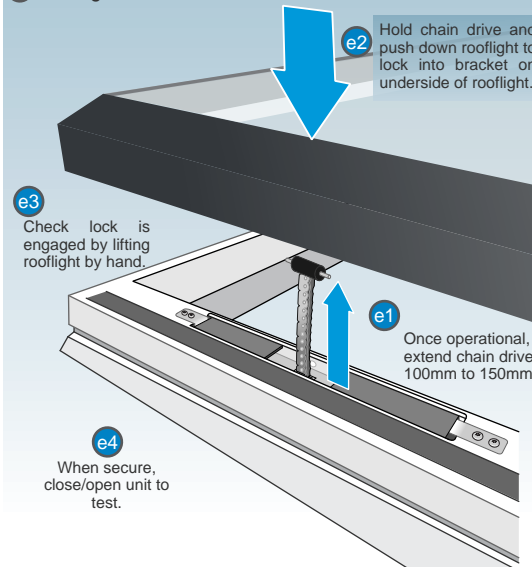

Installation Instructions

- ⚠** Ensure rooflight is supported in open position to avoid damage!
- a** Install roof covering to cover existing upstand in accordance with manufacturer's installation recommendations.
- b** Carefully remove roof light from its packaging and ensure that hinged rooflight is unlocked from frame and can be opened to 90°. If not disconnect, as shown.
- c** Mastic/Silicone around the edge of the upstand and correctly place kerb, ensuring it is located squarely to the upstand with hinges facing up-slope.
- d** Fix kerb to the builders upstand using the 125mm kerb fastener.
Ⓢ N.B. For front kerb fasteners, fix **ONLY** through pre-drilled holes to avoid electrical actuator/connections.
- #** Arrange for electrical connections to be made by a suitably qualified electrician to wire product as shown on reverse (See diagram # on Page 2).
- e** Ensure that the hinged rooflight is connected to the frame and locked into the closed position

Kerb Fixing

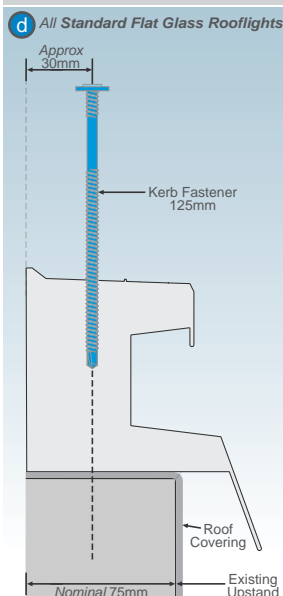

Opening Unit - IF Required

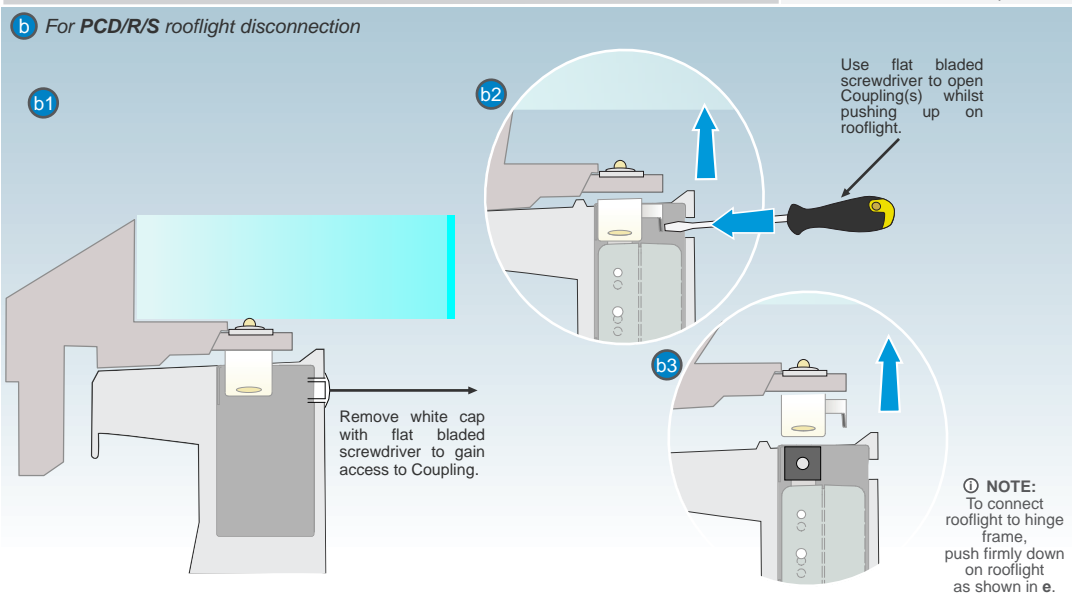

Ⓢ TECHNICAL SUPPORT: For any technical information/queries please contact your supplier.

The manufacturer operates a policy of continuous product improvement, and reserves the right to alter specifications at any time without notice. Every effort has been taken to ensure all details contained in this document are correct at the time of going to press but this document should be used only as a guide and does not in any way form part of a contract or warranty. It is the customer's responsibility to ensure that the product is suitable for the actual conditions of use, which are beyond the control of the manufacturer.



Warning!

Flat glass units are heavy.
Some units may require a mechanical lift

**For Standard Flat Glass
Rooflight on to Existing
Upstand**
See **Page 1** overleaf

Contents

i Please unpack and check that all correct parts are included and undamaged.

All Standard Flat Glass Rooflights



With either assembly, you will receive:

Kerb Fixings

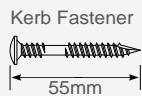

With either assembly, you will receive:

Opening Unit Extras



OR

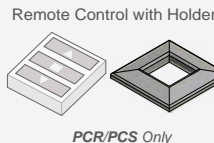

AND/
OR



Fixing Quantities

Length of Nominal Dome Side (mm)	Number of fixings per side
600, 750	2
900, 1050, 1200	3
1350, 1500, 1650	4
1800, 1950	5
2100, 2250	6
2400	7

(All fixings supplied in packs of 5.)

Installation

! Please note that all Health and Safety Regulations must be followed on site throughout the installation process.

Powered PCD/R/S Opening rooflight on to 150mm or 300mm kerb

! N.B. Kerb must be installed with hinges facing up-slope.

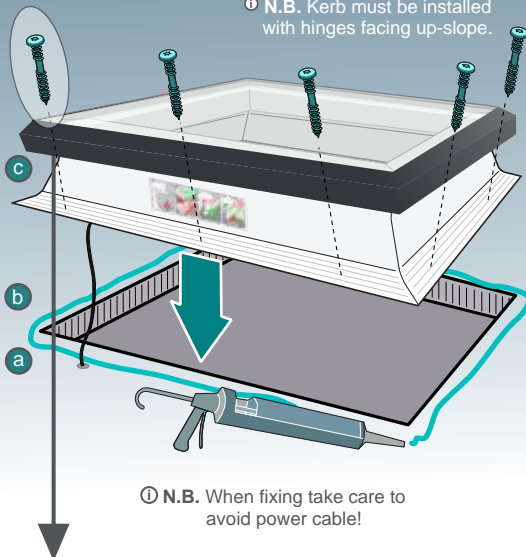

d Roof Covering Installation

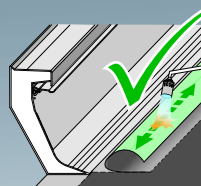

e

IMPORTANT:
You Will Receive Either

Type A 'CLAMP'



OR
Type B 'COVER TRIM'



Installation Instructions

- Feed power cable through roof cavity as shown.
- Mastic/Silicone around the edge of the roof opening and correctly position kerb, ensuring it is located squarely over the roof opening with hinges facing up-slope.
- Fix kerb to the roof using the 55mm kerb fastener.

See above **Fixing Quantities** table for the correct quantity of fastenings required for the size of the rooflight.

! N.B. Length of side refers to the nominal rooflight size (equivalent to inside base of kerb foot).
- Remove and retain kerb label then install roof covering up to lip, ensuring it **does not** foul clamp or cover trim. Install in accordance with manufacturer's installation recommendations
- Lock the roof covering clamp or cover trim down fully, following instructions on kerb label
- Arrange for electrical connections to be made by a suitably qualified electrician to wire product as shown below.

Kerb Fixing

c d All Standard Flat Glass Rooflights

- Kerb
- Roof Covering
- Structural Member
- Insulation

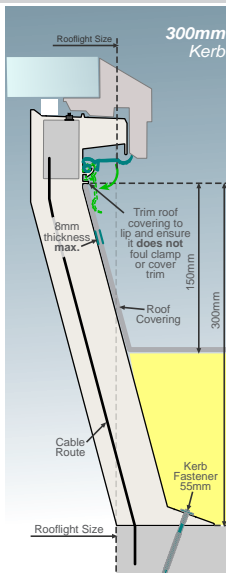
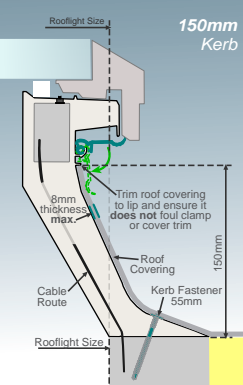

Opening Unit - Further Information

i Please select the relevant detail below for your product:

Chain Drive Unit Wiring Diagram for M&E Installer

PCD Option

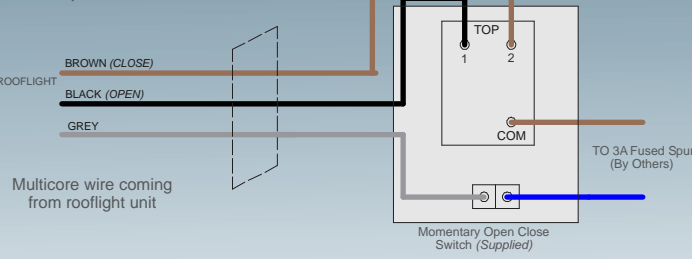

PCR Option

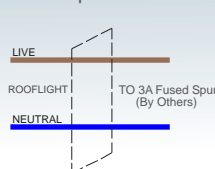

PCS Option

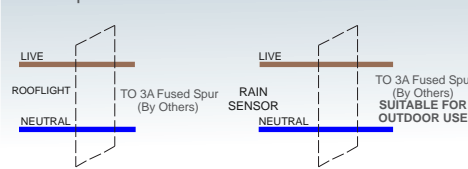

! Please note that all wiring and commissioning must be undertaken by a suitably trained and qualified person. The installer must ensure that all wiring runs, cable thickness and earthing etc. meet current regulations.

230V (AC) actuators must not be operated by supplying continuous power. They must only be operated using a "Spring to Centre" type rocker switch (as supplied on PCD option) or by using a suitable controller with a timed pulse for the opening period required (approx 60 to 120 seconds for full operation). Feeding continuous power to a 230V actuator will damage the unit over time and void any warranty. Actuators have a 12 month limited warranty from delivery of the unit.

! TECHNICAL SUPPORT: For any technical information/queries please contact your supplier.

The manufacturer operates a policy of continuous product improvement, and reserves the right to alter specifications at any time without notice. Every effort has been taken to ensure all details contained in this document are correct at the time of going to press but this document should be used only as a guide and does not in any way form part of a contract or warranty. It is the customer's responsibility to ensure that the product is suitable for the actual conditions of use, which are beyond the control of the manufacturer.