



Warning!
Flat glass units are heavy.
Some units may require up to 12 persons to lift



TB197-B

September 2017

Mardome Glass
Page 1

Vented on existing upstand

Contents

Please unpack and check that all correct parts are included and undamaged.

Mardome Glass (Unvented or Vented)

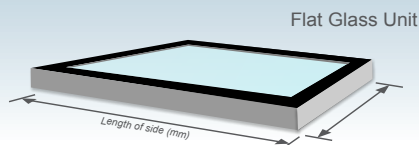

Mardome Glass (Vented)

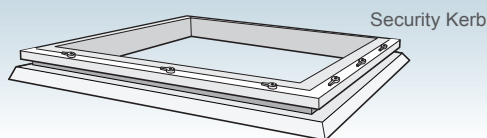

With this assembly, you will receive:
Security Kerb Latch Key

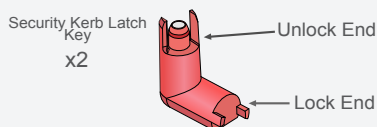

With this kerb assembly, you will receive:
Kerb Fixing

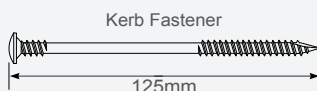

Fixing Quantities

Length of Nominal Dome Side (mm)	Number of fixings per side
600, 750	2
900, 1050, 1200	3
1350, 1500, 1650	4
1800, 1950	5
2100, 2250	6
2400	7

(All fixings supplied in packs of 5.)

Installation

Please note that all Health and Safety Regulations must be followed on site throughout the installation process.

Mardome Glass onto existing upstand

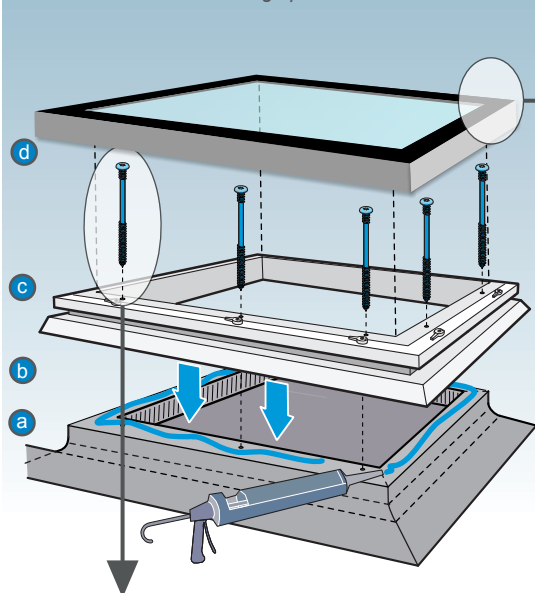

d Latch flat glass alignment for existing upstand OR sloping OR 300mm kerb

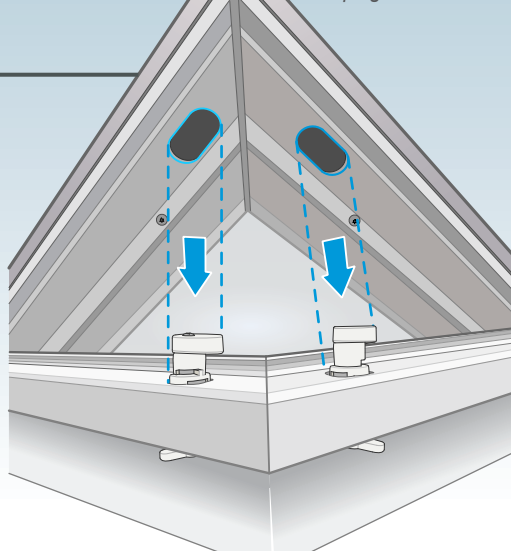

Installation Instructions

a Install roof covering to cover existing upstand in accordance with manufacturer's installation recommendations.

N.B. It is important that there should be no excessive build up of layers, the top surface should be level and free from any protrusions or projections which may prevent adequate weather proofing.

b Mastic/Silicone around the edge of the upstand opening and correctly place kerb, ensuring it is located squarely to the upstand.

c Fix kerb to the builders upstand using the 125mm kerb fastener.

d Ensure each latch is in the **Start Position** (parallel to the kerb, to align with the slots in the Flat Glass frame) then carefully remove glass from its packaging, and place squarely onto kerb ensuring it locates correctly over all latches.

e Rotate each latch ¼ turn anti-clockwise whilst firmly pushing glass unit down onto kerb, until the latch clicks into its **End Position**.

Remove latch operating tab by rotating ¼ turn clockwise, and discard.

f IF rooflight removal is subsequently required:

i. Insert the **Unlock** end of the red Latch Key into the bottom of the latch (with the **Lock** end facing outwards) and push upwards until it clicks into place.
ii. Rotate the latch ¼ turn clockwise whilst firmly pushing the rooflight down onto kerb, until the **Lock** end is parallel to the kerb, to release. Remove key by pulling downwards.
iii. Repeat for each latch, then lift off glass assembly.

g To refit the glass unit, insert the **Lock** end of the red Latch Key into the bottom of the latch with the **Unlock** end facing outwards.
i. Rotate the latch ¼ turn anti-clockwise whilst firmly pushing glass down onto kerb, until the latch clicks into its **End Position**.
ii. Remove key by rotating ¼ turn clockwise.
iii. Repeat for each latch.

Kerb Fixing

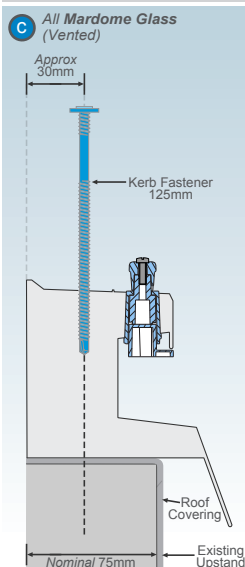

Installation

Please select the relevant detail for locking or unlocking rooflight:

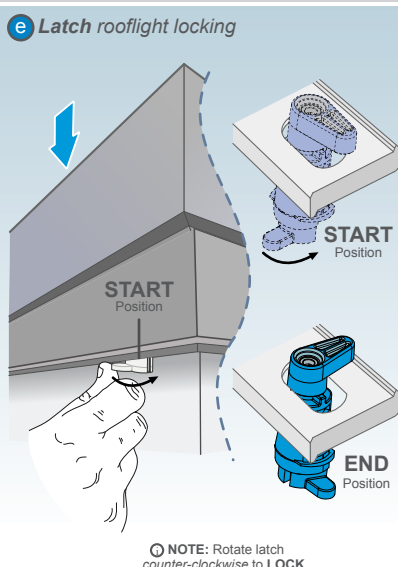

NOTE: Rotate latch counter-clockwise to **LOCK**.

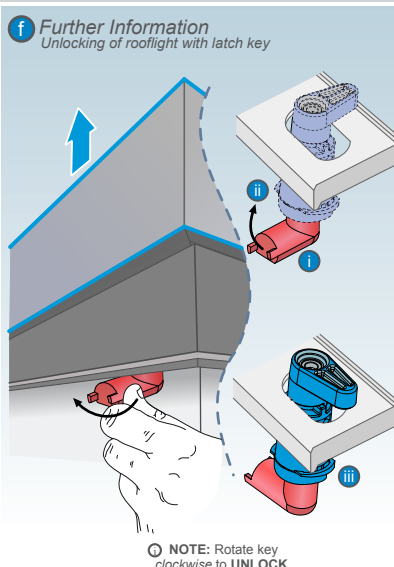

NOTE: Rotate key clockwise to **UNLOCK**.

TECHNICAL SUPPORT: For any technical information/queries please contact your supplier.

Brett Martin Daylight Systems operates a policy of continuous product improvement, and reserves the right to alter specifications at any time without notice. Every effort has been taken to ensure all details contained in this document are correct at the time of going to press but this document should be used only as a guide and does not in any way form part of a contract or warranty. It is the customer's responsibility to ensure that the product is suitable for the actual conditions of use, which are beyond the control of Brett Martin Daylight Systems.



Warning!
Flat glass units are heavy.
Some units may require up to 12 persons to lift



For Mardome Glass
on to Existing Upstand
See Page 1 overleaf

Contents

Please unpack and check that all correct parts are included and undamaged.

Mardome Glass (Unvented or Vented)

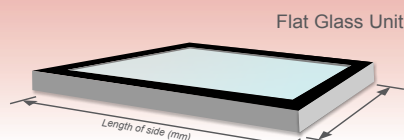

All Mardome Glass (Unvented or Vented)

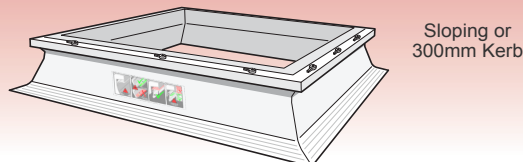

With this rooflight assembly, you will receive:
Security Latch Key

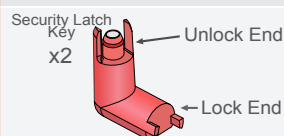

With this kerb assembly, you will receive:
Kerb Fixing

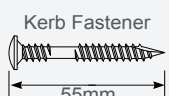

Installation

c Roof Covering Installation

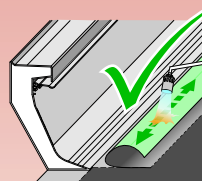

If required, lightly
torch roof covering.



WARNING:
Never apply direct heat
or naked flame to the roof light!

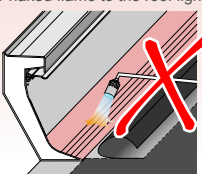

d IMPORTANT: Roof Covering Clamp Locking



Push along line as shown to lock.
DO NOT push on soft area!

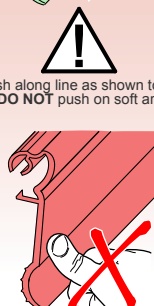

Installation

Please note that all Health and Safety Regulations must be followed on site throughout the installation process.

Mardome Glass unit on to sloping or 300mm kerb

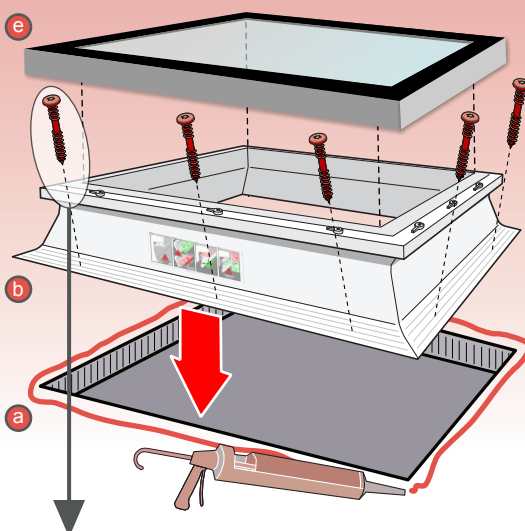

Kerb Fixing

b c All Mardome Glass (Unvented or Vented)

- Kerb
- Roof Covering
- Structural Member
- Insulation

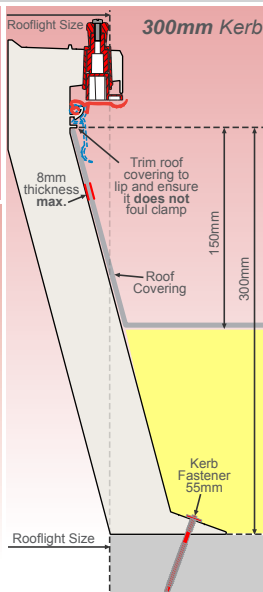
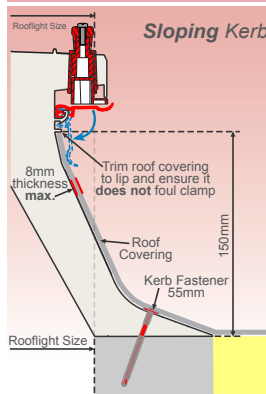

Installation

**Please select the relevant detail for locking or
unlocking rooflight:**

f Latch glass locking

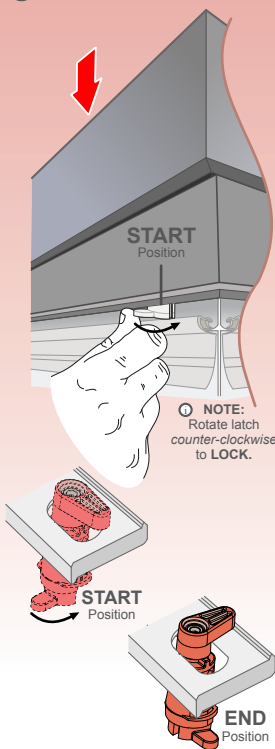

g Latch Further Information Unlocking of rooflight with key

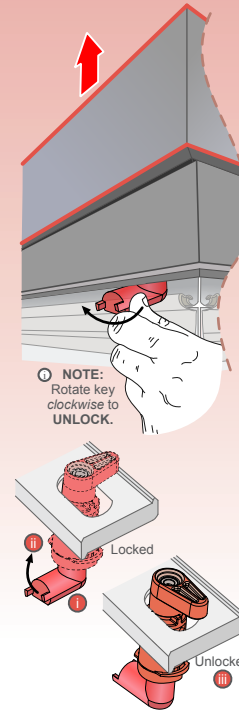

Fixing Quantities

Length of Nominal Dome Side (mm)	Number of fixings per side
600, 750	2
900, 1050, 1200	3
1350, 1500, 1650	4
1800, 1950	5
2100, 2250	6
2400	7

(All fixings supplied
in packs of 5.)

Installation Instructions

a Mastic/Silicone around the edge of the roof opening and correctly position kerb, ensuring it is located squarely over the roof opening.

b Fix kerb to the roof using the 55mm kerb fastener.

See above Fixing Quantities table for the correct quantity of fastenings required for the size of the rooflight.

N.B. Length of side refers to the nominal glass size (equivalent to inside base of kerb foot).

c Install roof covering up to lip, to stop under roof covering clamp, ensuring it does not foul clamp. Install in accordance with manufacturer's installation recommendations.

N.B. Never apply direct heat or naked flame to the rooflight! Ensure the roof covering does not foul clamp!

d Lock the roof covering clamp down fully, as shown.

e Ensure each latch is in the **Start Position** (parallel to the kerb, to align with the slots in the Flat glass frame) then carefully remove glass unit from its packaging, and place squarely onto kerb ensuring it locates correctly over all latches.

f Rotate each latch ¼ turn anti-clockwise whilst firmly pushing rooflight down onto kerb, until the latch clicks into its **End Position**.

Remove latch operating tab by rotating ¼ turn clockwise, and discard.

g IF glass unit removal is subsequently required:

i. Insert the **Unlock** end of the red Latch Key into the bottom of the latch (with the **Lock** end facing outwards) and push upwards until it clicks into place.
ii. Rotate the latch ¼ turn clockwise whilst firmly pushing rooflight down onto kerb, until the **Lock** end is parallel to the kerb, to release. Remove key by pulling downwards.
iii. Repeat for each latch, then lift off dome assembly.

h To refit the rooflight, insert the **Lock** end of the red Latch Key into the bottom of the latch (with the **Unlock** end facing outwards).

i. Rotate the latch ¼ turn anti-clockwise whilst firmly pushing rooflight down onto kerb, until the latch clicks into its **End Position**.
ii. Remove key by rotating ¼ turn clockwise.
iii. Repeat for each latch.

TECHNICAL SUPPORT: For any technical information/queries please contact your supplier.

Brett Martin Daylight Systems operates a policy of continuous product improvement, and reserves the right to alter specifications at any time without notice. Every effort has been taken to ensure all details contained in this document are correct at the time of going to press but this document should be used only as a guide and does not in any way form part of a contract or warranty. It is the customer's responsibility to ensure that the product is suitable for the actual conditions of use, which are beyond the control of Brett Martin Daylight Systems.